

January 13, 2020

Things are beginning to take shape as we pass the three-month mark since the beginning of the renovation of the sanctuary and Ashantilly Wing. Up until now, the bulk of the work has involved old walls coming down and materials going out. Now we are beginning to see new walls going up and new materials arriving on-site. This month's Renovation Update details work completed to-date and outlines several of the key tasks that will be accomplished in the coming weeks. Also included are several photos detailing the progress and updated renderings of what the renovated spaces will look like upon completion. A special thank you for the continued hard work of our Building Committee members – Tom Baltzell (chair), Karen Schmidt, and Matt Hodgdon – who are meeting nearly every week to help oversee and finalize plans for this transformational project in the life of our church.

- Renovation Transition Team & Building Committee

## A Visual Tour of The Construction Site

As of January 9, 2020

### Sanctuary (facing front)

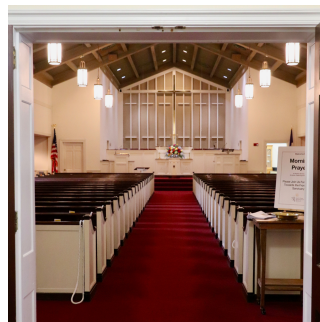

September 28, 2019



October 30, 2019



January 9, 2020

*Since October 2019*

*Existing transept walls removed  
Existing chancel walls removed  
New footers dug and poured*

### Ashantilly Transept & Gathering Space



New footers for Ashantilly transept and gathering space. (12/5/19)



New gathering space foundation and walls (1/9/20)



New Ashantilly transept walls going up. (1/8/20)

## ...Looking Back

Completed Since November 2019

- Demolition completed on transept and chancel walls.
- Footers dug and concrete poured for widened transepts and new gathering space.
- Asbestos abatement completed.
- New steel installed for both transepts.
- Roofing, liturgical furniture, audio/visual, and window details finalized.

## Looking Ahead...

Anticipated Progress in January/February 2020

- Construction of transept, gathering space, and west chancel walls continues.
- Roof installation on sanctuary, Ashantilly Wing, and additional renovated spaces.
- HVAC ductwork and new conduit installed.
- Complete structural stabilization of interior walls in nave.

## Updated Interior Renderings

### Sanctuary

*Plantation shutters on windows*

*New organ case with exposed pipes and a suspended cross in front*

*Updated lighting and sound*

*New pulpit and liturgical furniture*



*New solid sapele wood pews*

*Built in A/V capability with retractable projection screens on transept walls*

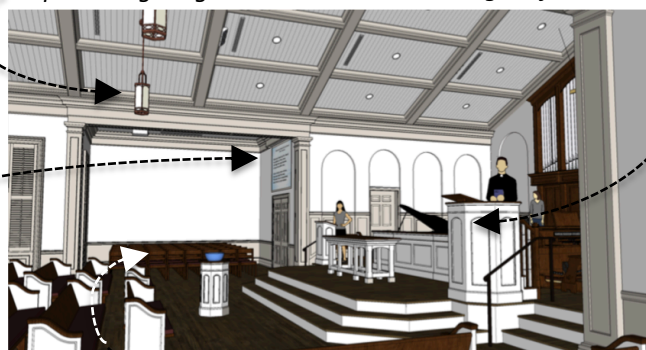

*Custom wooden chairs with cushions in Ashantilly transept for added space flexibility*

### Gathering Space Outside Ashantilly Transept

*Doors to sanctuary*

*Comfortable seating and gathering space connected to sanctuary*

*Doors to kitchen parking lot*



*Ramp providing handicap accessibility to chancel*

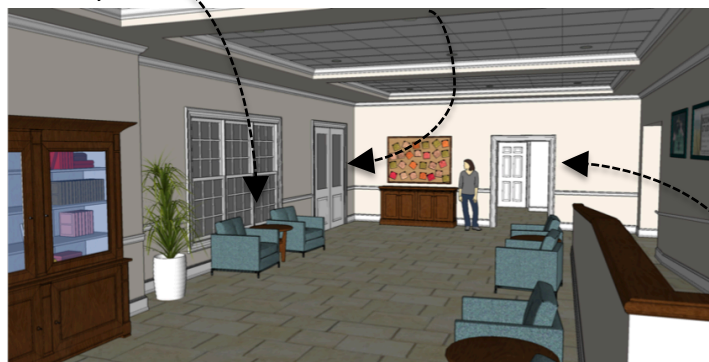

*Access to handicap accessible bathrooms and church kitchen*

## Questions?

**Building Committee:** Tom Baltzell (Chair), Karen Schmidt, Matt Hodgdon, Alan Dyer, Rhonda Hambricht

**Renovation Transition Team:** Leslie McCracken (Chair), Anne Aspinwall, Annie Franklin Arvin, Leslie Carlton, Ben Bryson, David Stewart, Rhonda Hambricht, Suzanne Morrison, Tom Haughney, Walter Lynn, Alan Dyer